

## WEEKLY UPDATE WITH PHOTOS For week commencing 11<sup>th</sup> March 2024

- Ground to Eighth floor party walls are now complete.
- Screeding from ground to Eighth floors are complete.
- Sand and cement screed to the ground floors will follow later.
- We have completed the blockwork to the mechanical and electrical risers with plant room and bin store block walls now complete.
- The external brickwork has now progressed to the Fifth floor.
- We will continue the heating and water distribution pipework installation, this has been completed to the Eighth floor.
- The external insulation is now complete to the Fifth floor with Sixth floor to follow.
- Electrical wiring is progressing on site and containment to the communal areas is in progress. This has now been completed to the Eighth floor.
- Electrical second fix has now started to the First floor.
- Solar panels are now in position on the Eighth floor roof.
- Internal doors and frames are being fitted and are currently complete to the Second and third floor.
- Kitchen installations have now started, and we now complete on the First and Second floor.
- Core B lift has been installed with Core A progressing well.



**Tony Johnson**  
Senior Site Manager

### Contact our Social Value and Community Team

☎ 0800 032 6760 (free phone) 8am to 8pm, seven days a week

✉ residents@hill.co.uk

✍ The Powder House  
Gunpowder Mill  
Powdermill Lane  
Waltham Abbey  
Essex, EN9 1BN



# Thamesview House Bulletin

## 11<sup>th</sup> March 2024

- Tiling to kitchens and bathrooms have now started to the First floor and due to progress to the Second floor.
- The site will **not** be open on Saturday 09/03/2024.



*5<sup>TH</sup> Floor Balconies Waterproofed*



*GF Soffit Insulation Complete*

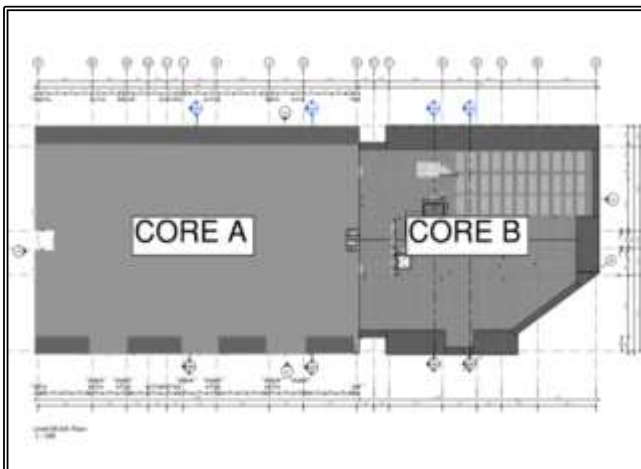

*Hoarding Change*



*Core Identification*



**Tony Johnson**  
Senior Site Manager

### Contact our Social Value and Community Team

☎ 0800 032 6760 (free phone) 8am to 8pm, seven days a week

✉ residents@hill.co.uk

✍ The Powder House  
Gunpowder Mill  
Powdermill Lane  
Waltham Abbey  
Essex, EN9 1BN

